



#DigitalPaceForDentalPeace

ceramill[®] motion 3



THE INHOUSE MOVEMENT[®]

CERAMILL MOTION - THE SUCCESS STORY OVER THE YEARS



ceramill® motion

The Ceramill Motion success story began in 2009. With the advance of digital technologies and the advent of CAD/CAM in the dental laboratory, the job profile of the dental technician has changed.

As a pioneer in the dental CAD/CAM sector, we played a decisive role in this development with the Ceramill Motion 1 as the first complete system on the market.

ceramill® motion 2

In 2012, the 2nd generation of machines was the first compact hybrid milling unit (dry and wet processing) with the widest range of indications on the market and was pivotal to the "In-house Movement": it brought value creation, already thought lost to industrial fabrication centers, back to the laboratories.

This resulted in a trend reversal in the market and manifested Amann Girrbach's role as a market leader and innovator in the dental CAD/CAM sector.

ceramill® motion 3

Ceramill Motion 3 is the latest generation of machines. It continues the Motion success story and leverages all the advantages of digitization. This benefits the laboratory in terms of efficiency and quality. At the same time, Ceramill Motion 3 simplifies handling of the digital infrastructure and reduces application complexity.

DIGITAL PEACE OF MIND

With the Ceramill Motion 3, you will be adding the world's most intelligent 5-axis hybrid machine to your laboratory. The milling unit not only combines wet and dry processing in a single machine, but also enables an end-to-end digital workflow. On the one hand, this provides you with a maximum diversity of materials and indications. On the other hand, its digital features enable you to manage your laboratory infrastructure in an uncomplicated manner and to optimize it on an ongoing basis.

Due to the connection to the AG.Live platform, you have the possibility of accessing the Ceramill Motion 3 at any time and from anywhere, to receive orders safely and quickly, and to monitor everything related to production and customer service. At the same time, you benefit from the integrated analysis tools, which you can utilize to make your business pro-

cesses even more efficient. The intuitive user interface and guided CAD/CAM production and maintenance allow you to focus entirely on your core business. In addition, the tools and blank holders of the Ceramill Motion 3 are equipped with RFID technology, thus ensuring process reliability and enormously simplifying the handling of tools and consumables. The automatic reminder function for maintenance, care and service cycles provides for additional reliability and a long service life of the machine and leaves the operator free to focus on the essentials. The innovative machining strategies for rotational milling, such as the Carving Mode or the Detailing Mode, round off the versatility of the system.

RELAXED INTO THE DIGITAL DENTAL FUTURE

- Access the world's smartest 5x hybrid machine, anytime and worldwide
- Save time and money with guided CAD/CAM production and maintenance
- Analyze and optimize workflows automatically
- Unsurpassed versatility and processing quality

AG.LIVE - SMART, STRAIGHTFORWARD AND DIGITAL - THE NEW COMFORT IN OPERATION AND MANAGEMENT

The Ceramill Motion 3 and the Ceramill Matik open the door to the digital world for users.

The main focus in development was placed on 3 essential fields for users when dealing with CAD/CAM fabrication.

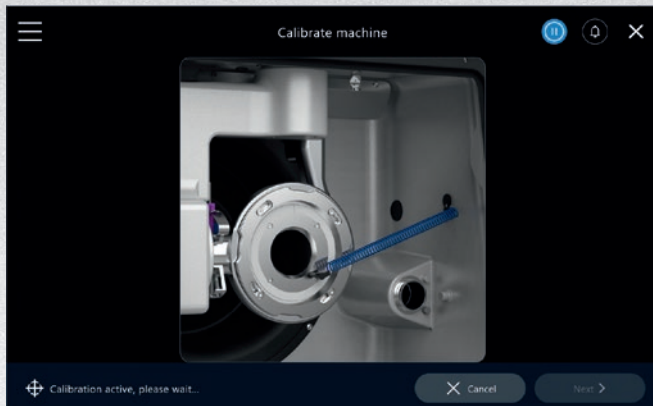

FOCUS ON THE ESSENTIALS - USER-FRIENDLINESS

The first field related to user-friendliness, where user interaction with the machine was revolutionized most notably. Whereas in the past, users had to refer to operating instructions, maintenance manuals and other written documents, the essential operating, servicing, handling and maintenance steps can now be conveniently tracked and implemented step by step on the screen, supported by images and videos. Menu navigation is kept simple and intuitive here and is additionally supported by technical aids (e.g. RFID for tools and material holders) to ensure a maximum level of safety in the fabrication process.

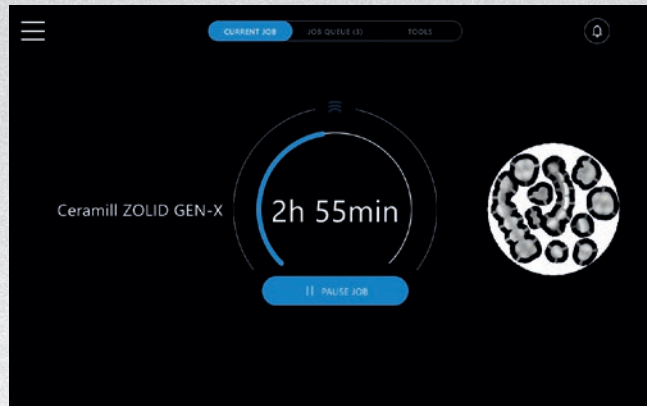

STAY ON TOP OF THINGS IN FABRICATION - THE AG.LIVE PORTAL

It has never been easier to keep track of things - worldwide. Whereby it makes no difference whether the status of the different machines, the maintenance status or simply a brief look at the machine is desired. In future, the portal per se will also be offering the additional option of providing an overview of orders, actively managing delivery times, and thus responding optimally to the needs of your own customers.



INTELLIGENT MANAGEMENT OF PORTFOLIO AND RESOURCES - AG.LIVE ANALYSIS AND E-STORE

Unique on the market - AG.live in connection with the eShop now offers options to also manage the business of production in the background as well as the managing of resources. For example, evaluations of material consumption for indications and tools are supported, as is the direct store connection, which enables convenient ordering as required.

AG.LIVE
PORTAL

GUIDED WORKFLOWS

- _ Machine handling
- _ Service and maintenance work



SERVICE OVERVIEW

- _ Cleaning and maintenance calendar
- _ Documentation
- _ Fast service



STATUS OVERVIEW OF PRODUCTION

- _ Conveniently from anywhere



STOCK MANAGEMENT

- _ Materials and tool management
- _ Consumption-related orders



BUSINESS REPORTING

- _ Analysis of production:
- _ Indication-related
- _ Resource-related
- _ Deadline-related



AG.LIVE - THE DIGITAL ENVIRONMENT
FOR MAXIMUM COMFORT

ceramill motion 3

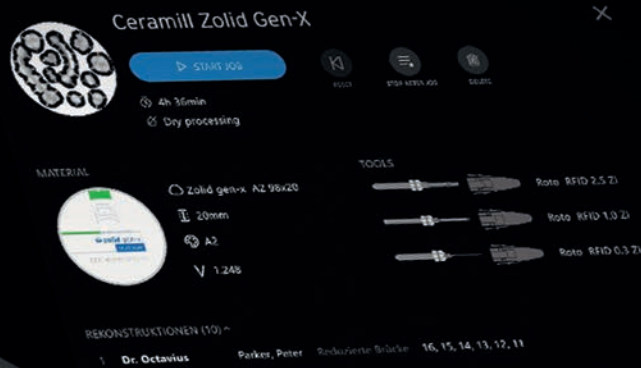

ceramill® motion 3

- ▶ Access the world's smartest 5-axis hybrid machine, anytime and anywhere
- ▶ Maximum user-friendliness and process reliability due to user interface and RFID technology
- ▶ Optimal capacity and resource management owing to AG.Live's smart analysis functions
- ▶ Fully automated dental arch restorations of the highest quality due to innovative sculpturing technology (C-Clamp)

#DigitalPaceForDentalPeace



AG.Live - The digital interface

The gateway to the digital environment

Direct user interface 10" - The digital communication unit

Intuitive operation for maximum comfort

Autocalibration - Equals convenient quality assurance

Automatic calibration for permanent highest restoration quality

RFID tools and material holders - The resource manager

RFID for maximum process reliability and optimal management

Interior HD camera - Full view

Camera for remote monitoring of the production process



GRINDING



TIME SAVINGS WHEN GRINDING



MILLING



THRILLING



CARVING

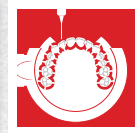

SCULPTURING



**READY FOR
AG.LIVE**

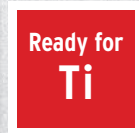

CARVING - THE SYMBIOSIS OF POWER AND INTELLIGENCE



The patented Carving mode - allows glass and hybrid ceramics to be processed with a saving in time of approx. 60 %. This special grinding technique removes excess material in its entirety, thus bypassing the need to grind the block down to its actual geometry. The process, which to date is unique in dental CAD/CAM technology, results in massive time savings and is roughly equivalent to machining with two spindles (approx. 15 min/crown).

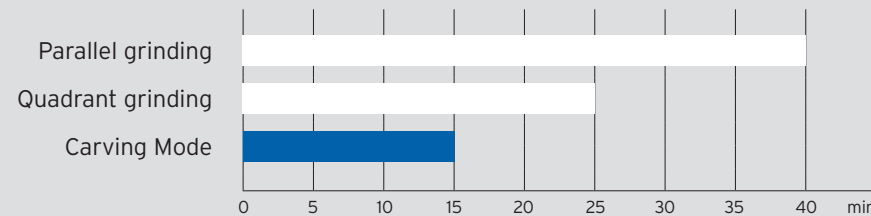

HIGH DEFINITION CAD/CAM FOR ALL MATERIALS AND INDICATIONS

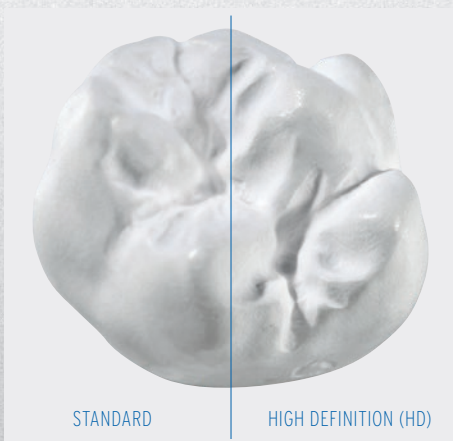

MILLING IN HD QUALITY:

Owing to the interaction of the high-precision (super) high-frequency spindle, a meticulously developed milling strategy and ultra-thin "HD milling cutters", the entire range of millable Ceramill CAD/CAM materials can be processed at a quality level that sets new standards.



- _ Maximum detail work for highest possible esthetics
- _ Most delicate structures for minimal preparation and post-processing of the restoration

UHD SCULPTURING - PURE ESTHETICS

The stability of the milling machines and a specifically developed holder (C-Clamp) in combination with the optimal milling strategies ensure perfect detailing of anterior and posterior tooth restorations.

Here, the material blanks can be machined vertically to accommodate fine structures during CAD/CAM fabrication, e.g. for highly detailed anterior tooth restorations. This makes tedious reworking and the grinding of connectors in highly esthetic areas a thing of the past.

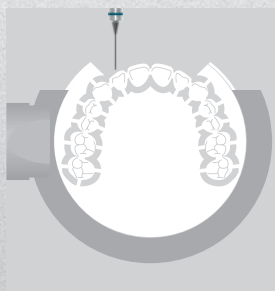

C-CLAMP - THE SCULPTOR

Maximum attention to detail also given in the peripheral area

- _ Maximum time savings during reworking due to CAD/CAM detailing of previously inaccessible restorations**
- _ Stable holders, stable machine setup and validated milling strategies for a highly esthetic result, also on the tooth surfaces**

DNA GENERATION. POWER + DENTAL INTELLIGENCE = PERFORMANCE

Thanks to in-house development of all the elementary components, and particularly the new control units, we can meticulously adapt our milling units to the specific requirements of dental technology and continuously refine them. An unmistakable profile results from the precision, speed, and CAM processes, which are precisely adapted to the mechanical properties of dental materials—we call this the “Ceramill DNA”.

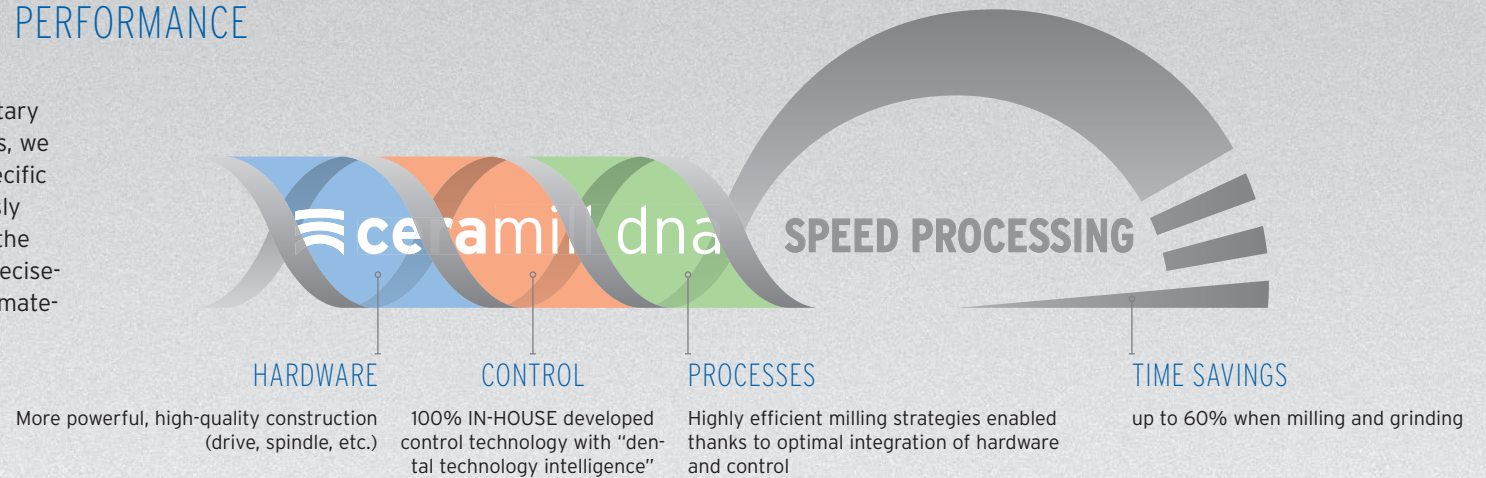

ENGINEERED, PRODUCED, AND TESTED IN AUSTRIA

Our Ceramill units are manufactured 100% in-house and exclusively at the Amann Girrbach Headquarters in Austria.

Due to our decades of experience in CNC technology as well as our considerable development competence in the CAD/CAM area, we possess the expertise to develop our machines from scratch and to manufacture these on site.





AMANNGIRRBACH

AUSTRIA (HEADQUARTERS)

Amann Girrbach AG
Koblach, Austria | +43 5523 62333-105
austria@amanngirrbach.com

GERMANY

Amann Girrbach GmbH
Pforzheim, Germany | +49 7231 957-100
germany@amanngirrbach.com

ITALY

Amann Girrbach Italia srl
Verona, Italy | +39 045 9813970
europe@amanngirrbach.com

FRANCE

Amann Girrbach France SAS
Jossigny, France | +43 5523 62333-105
europe@amanngirrbach.com

NORTH AMERICA

Amann Girrbach North America, LP
Charlotte, NC, U.S.A. | +1 704 837 1404
america@amanngirrbach.com

BRAZIL

Amann Girrbach Brasil LTDA
Curitiba, Brazil | +55 41 3287 0897
brazil@amanngirrbach.com

ASIA

Amann Girrbach Asia PTE LTD.
Singapore, Asia | +65 6592 5190
singapore@amanngirrbach.com

CHINA

Amann Girrbach China Co., Ltd.
Beijing, China | +86 10 8886 6064
china@amanngirrbach.com

JAPAN

Amann Girrbach Asia Japan
Kyoto, Japan | +81 75 283 1239

WWW.AMANNGIRRBACH.COM